

40-306AC

OLD AIR PRODUCTS www.oldairstproducts.com
DIVISION OF COLD AIR PRODUCTS INC.

1201 Forum Way South - Fort Worth, TX 76140
(817) 531-2665 - FAX (817) 531-3257

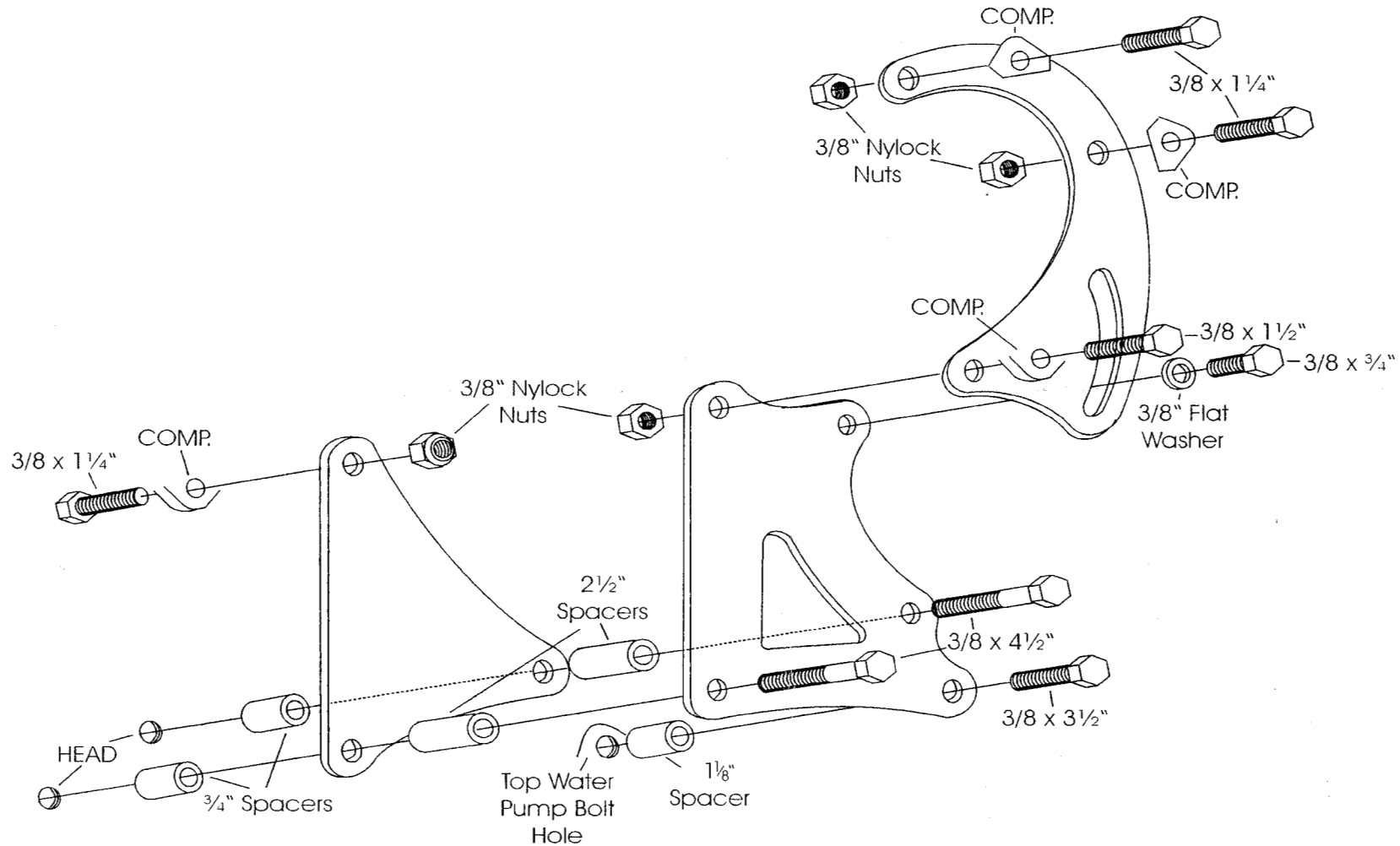

As with any part of this nature, make sure it fits your application before painting or plating. Parts that have been painted, plated, or modified may not be returned.

305, 306 A.C. AND ALT.

SMALL BLOCK CHEVY - SERPENTINE

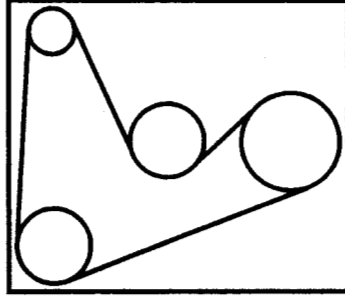

Belt Routing

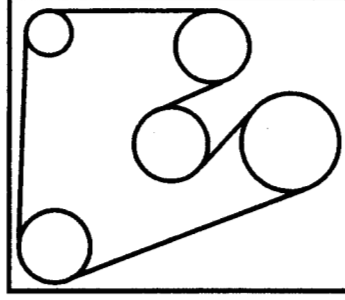

Belt Routing
with Power Steering

This System was designed to be used with a reverse rotation water pump G.M. part number 88894005. These pumps were used on 1989-93 caprice cars and 1988-95 trucks as well as a few other applications.

The part numbers for factory G.M. steel pulleys are as follows:

Water Pump Pulley	10085760
Crankshaft Pulley	10085754
Power Steering Pump Pulley	10085755
Alternator Pulley	1985964

If your engine is a 1986 or earlier, and only has one bolt hole in the right head, it will be necessary to drill and tap one hole in the head. Using the brackets as a template, mark the location on the head. Drill with a 5/16" bit and tap 3/8-16". The number of washers between the head and 1/4" spacer will vary with different castings.

The compressor bracket uses a Sanden 508 aftermarket compressor with multi-groove pulley. The alternator bracket is designed for the older G.M. 10SI and 12SI or the newer G.M. CS130 alternators. The center to center mounting points on these alternators are 6 9/16 inches.

This system is designed to use a six rib belt 8 1/8" long. If using our power steering pump bracket use a belt length of 100." Belt tension: Install the belt and tension. Run the engine for 3 to 5 minutes to seat the belt, then reset tension. Belt should be tensioned to 1/4" deflection along its longest span.

NOTE: Sanden compressors have a 7 rib pulley. On our system the belt will run in the front six grooves.