

Alternator & Power Steering Pump Mount 40-601L

Chevrolet Big Block Engines
with Short Water Pump



Division of Cold Air Products Inc.

1201 FORUM WAY SOUTH, FORT WORTH TX 76140

817-531-2665

24 hour FAX 817-531-3257

www.oldairstproducts.com

Email - chill@oldairstproducts.com

Technical Information

This bracket system is designed for big block Chevilles, El Caminos and other front steer applications where space is limited for power steering pump clearance. AS WITH ANY PART OF THIS NATURE, MAKE SURE IT FITS YOUR APPLICATION BEFORE PAINTING OR PLATING. PARTS THAT HAVE BEEN PAINTED, PLATED OR MODIFIED MAY NOT BE RETURNED.

To insure proper function and installation of this product please read the following detailed Instructions (steps 1-4) attached to this information page.

Unless noted be sure to start all bolts before tightening.

On some early engines the accessory holes in the head are larger 7/16" holes. In this case a 3/8-16 heli-coil must be installed. They are available at most auto parts and hardware stores.

Belt Information

We use a belt length of 58-1/2-59-1/2" for the alternator mount and a 41-1/2" - - 42" belt for the power steering mount in our shop. However this can vary with the diameter of your pulleys.

Belt Routings Without A.C.

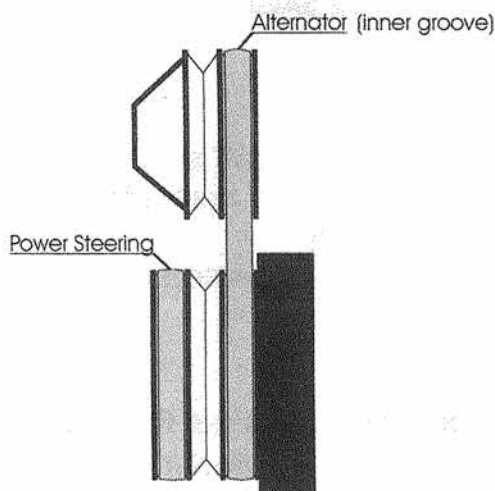

Belt Routings With A.C.

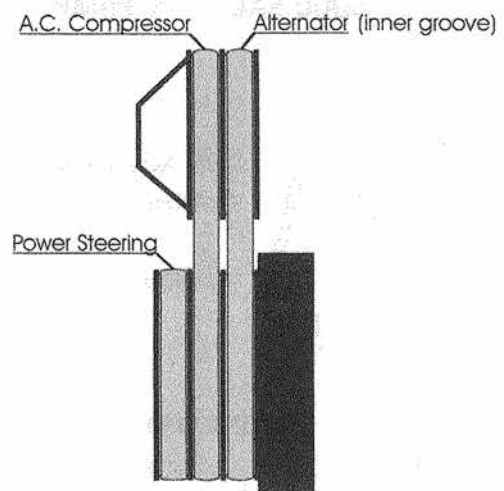

Power Steering Information

Chevrolet first used the attached reservoir pump in 1961 and they are still in use today in a few applications. Due to the rarity and high cost of the factory Chevelle remote reservoir pumps we designed this bracket system for the readily available later model pumps. (See pump recommendations and application below). Due to the lack of space factory big block Chevelle pumps may not work with this bracket system.

The following list of power steering pumps are just a few of the many available pumps that we have used with our power steering pump brackets. All reservoirs **MUST HAVE THE TWO ATTACHMENT POINTS ON THE BACK OF THE RESERVOIR AS SHOWN AND THE CORRECT PLACEMENT OF THE RETURN LINE THAT WILL WORK WITH THE APPLICATION.**

A 1 groove V-8 Chevrolet power steering pulley must also be used for correct belt alignment.

POWER STEERING PUMP PULLEYS
1 Groove Bolt-on Pulley
1 Groove Press-fit Pulley

CHEVROLET PART #
GM Discontinued - (Available from Old Air Products)
93430150

This bracket system requires the removal of both upper and lower attachment point bolts or studs. Use provided hardware in our bracket kit for proper installation. (See rear view of pump diagram below)

Rear View of Pump

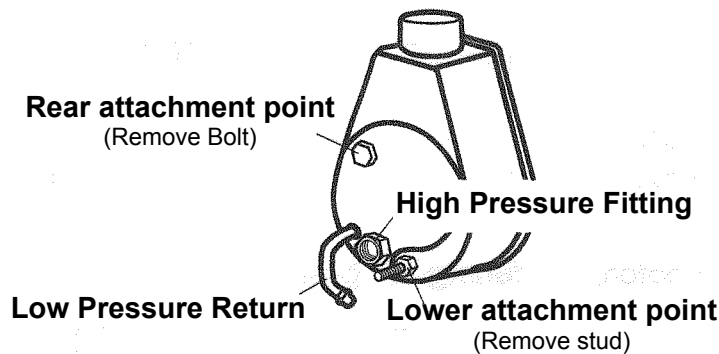

Pulley Dimension

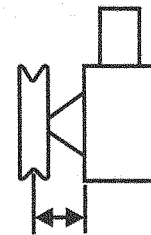

V-8 power steering pump pulleys measure 1-13/16" center of pulley to face of pump.

Pump Applications

6000 Saginaw Pump

5/8" keyed shaft for nut retained pulley
 Inverted flare fitting

Applications pumps were found on:

1970-74 Camaro w/ V-8
 1971-74 Chevelle, Malibu w/ V-8

6012 Saginaw Pump

3/4" smooth shaft for press-fit pulley
 Inverted flare fitting

Applications pumps were found on:

1975-78 Camaro w/ V-8
 1975-77 Malibu w/ V-8

STEP 1:

NOTE: On some early engines the accessory holes in the heads are larger 7/16" holes. If this is the case a 3/8" heli-coil must be installed. They are available at most auto parts and hardware stores.

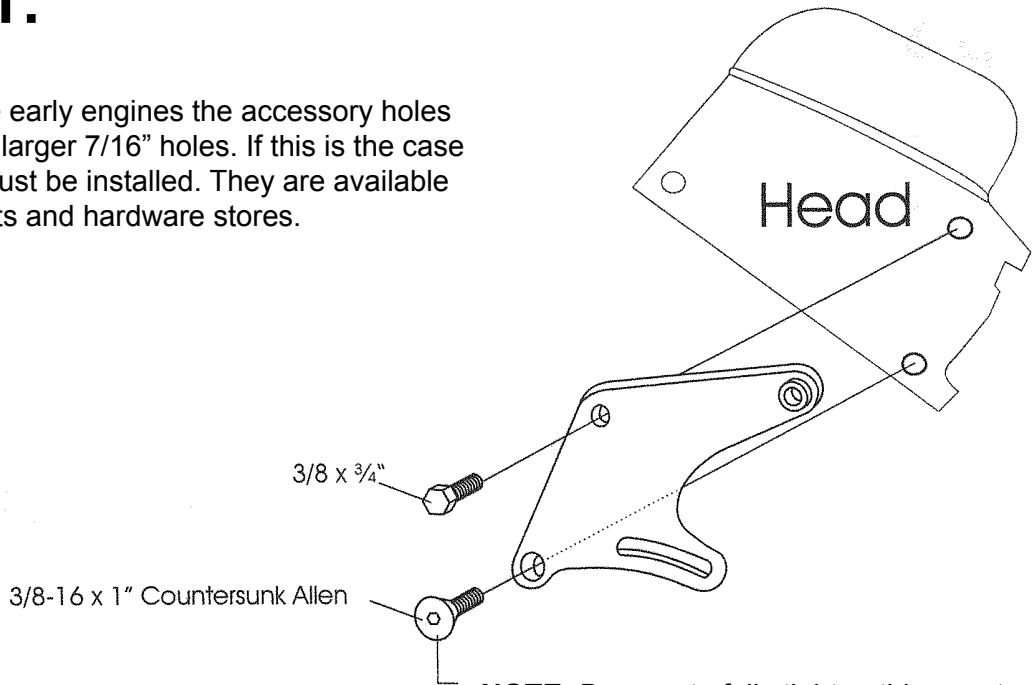

NOTE: Be sure to fully tighten this countersunk allen bolt as it will not be accessible after the following installation steps.

STEP 2:

NOTE: Assemble both front and rear bracket plates to power steering pump before attaching to engine block.

NOTE: See power steering pump information page for pump installation note and diagrams.

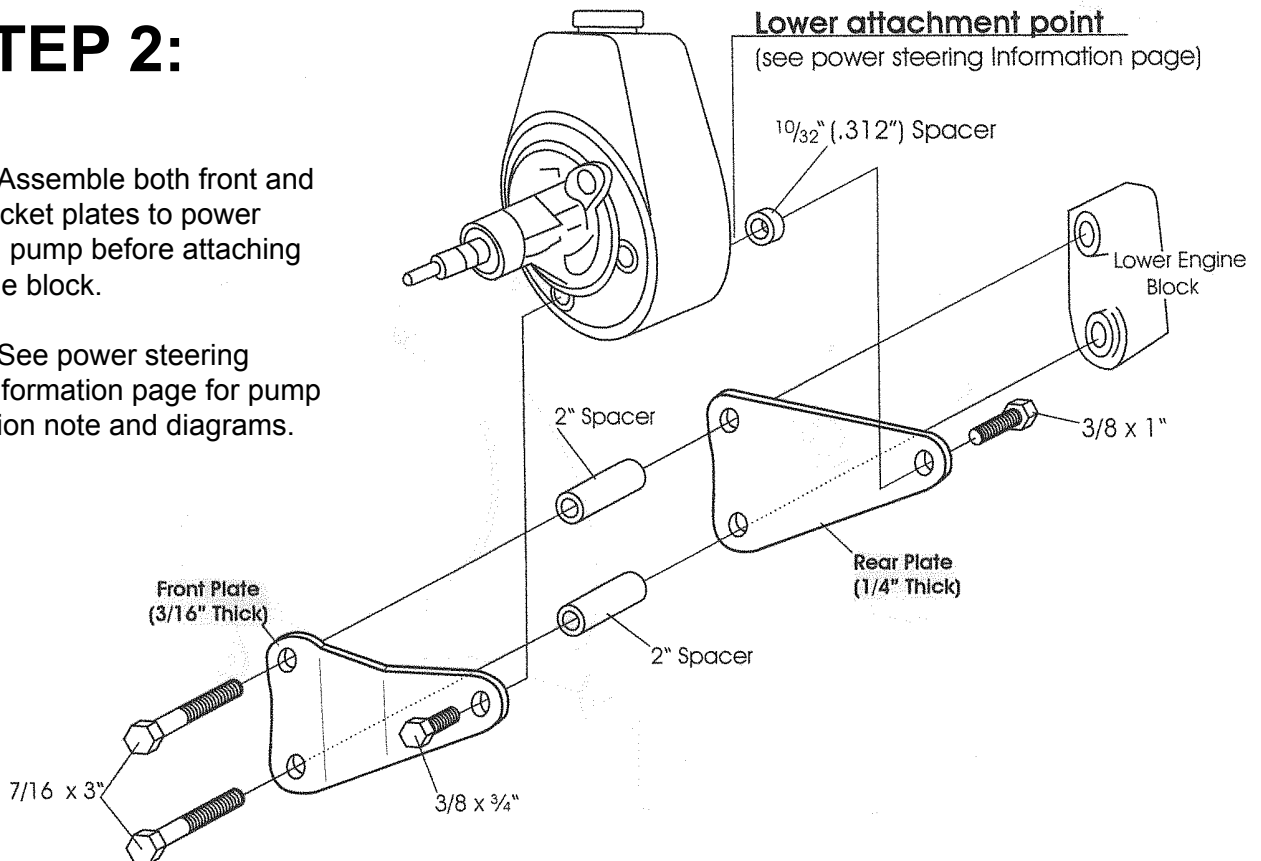

STEP 3:

NOTE: See power steering pump information page for pump installation note and diagrams.

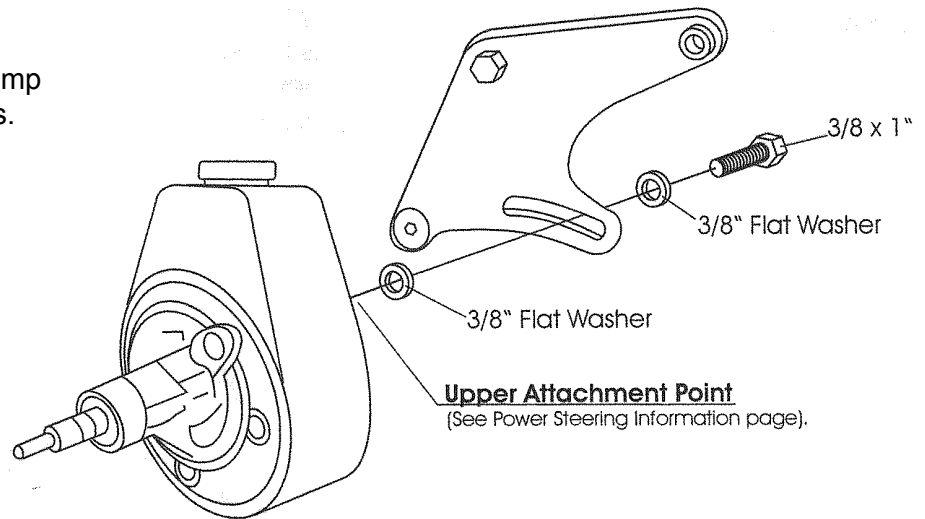

STEP 4:

